

**LOCALLY
MANUFACTURED**

CBI electric
low voltage

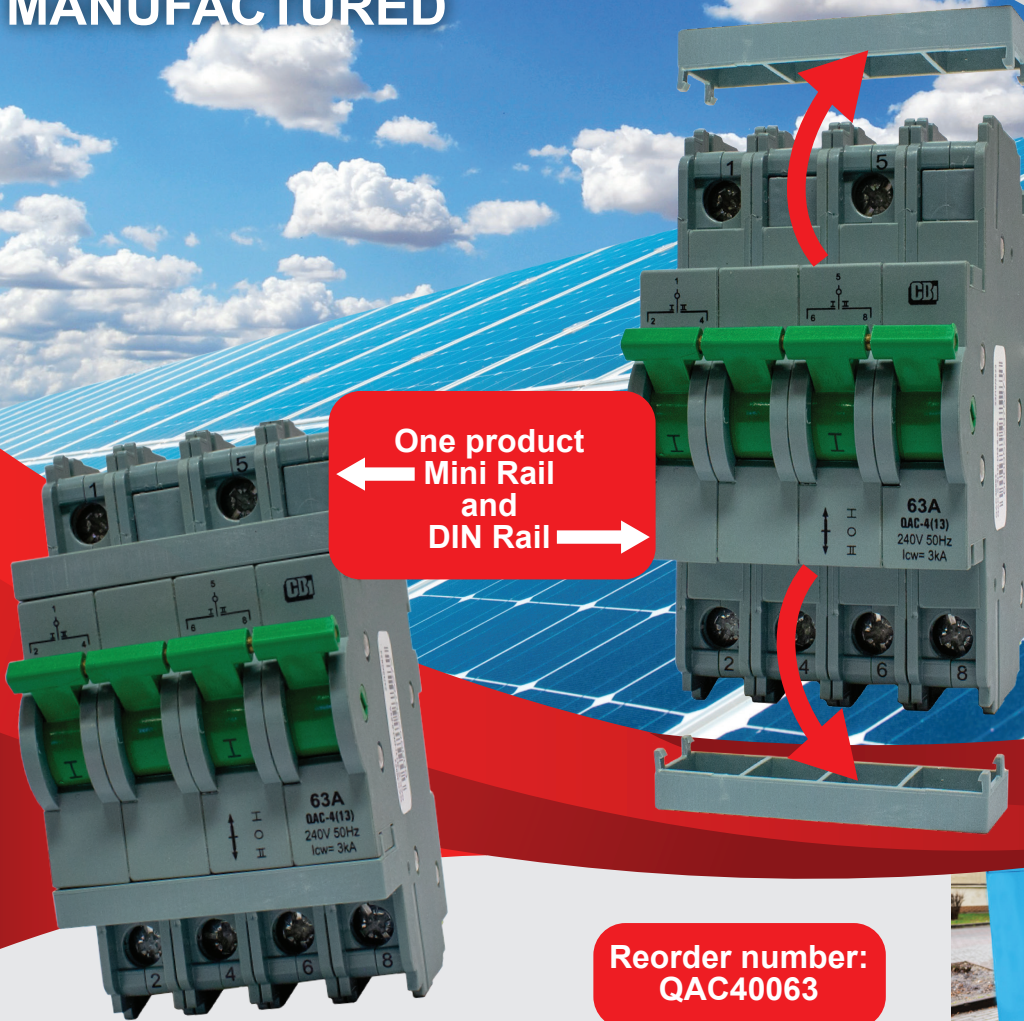

NEW

Reorder number:
QAC40063

CBI RAIL MOUNTED CHANGEOVER SWITCH

FEATURES

- Compact design at 52 mm for single phase
- High quality contacts
- Easy to install and operate
- Suitable for residential application
- 3 Switch positions - main supply, alternative supply and off
- Available for single phase installations
- Mini and DIN rail mount (dual) with removable clips for 45 mm and 57 mm escutcheon
- Rated at 63 A
- IEC 60947-3 compliant



CBI RAIL MOUNTED CHANGEOVER SWITCH

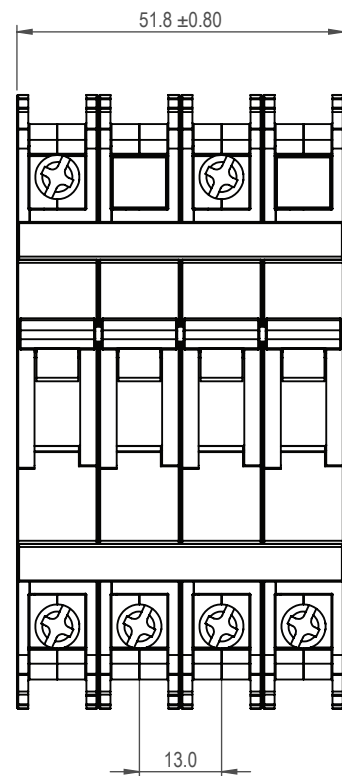
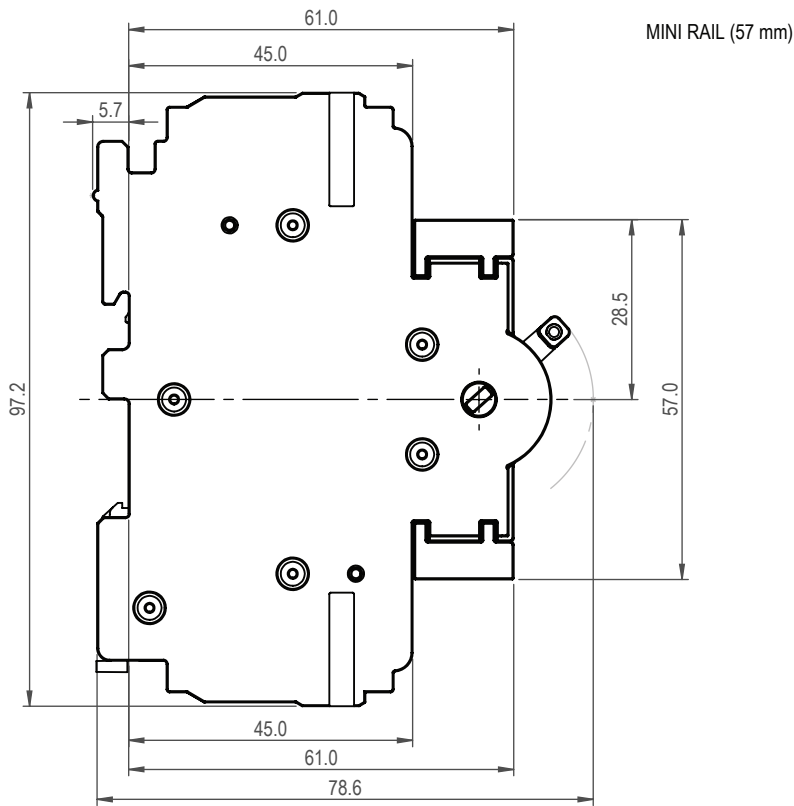

TOLERANCE ±0.4 mm UNLESS OTHERWISE STATED

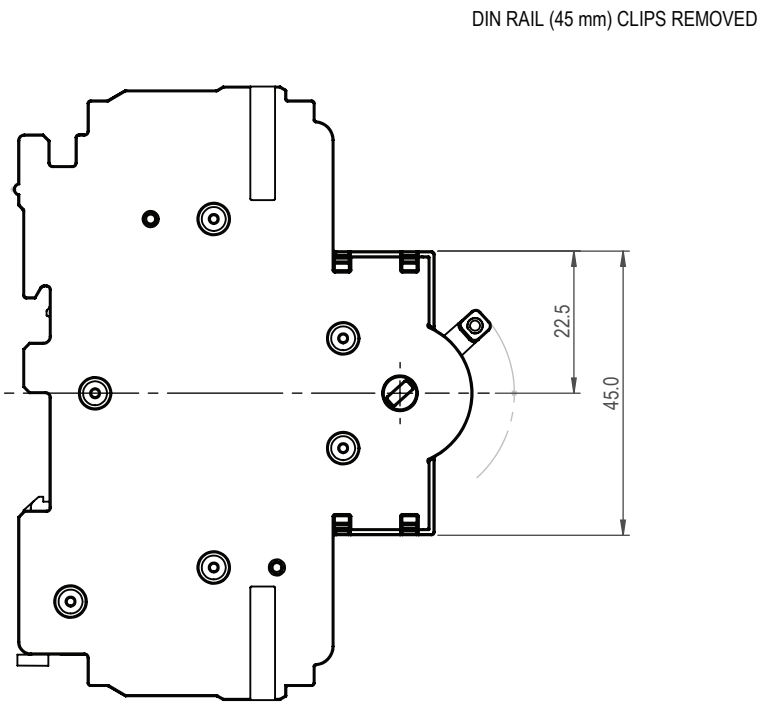

FOR ALL OTHER DIMENSIONS REFER TO MINI RAIL VERSION

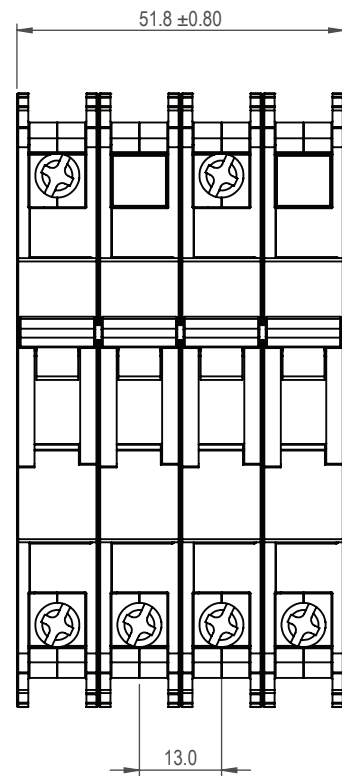

TOLERANCE ±0.4 mm UNLESS OTHERWISE STATED